

NOTICE: BEFORE LEAVING THE REGIONAL TOURNAMENT TODAY, PLEASE COMPLETE THE ADVANCEMENT FORM AND LEAVE IT ALONG WITH THE \$30.00 CASH or \$32.00 CARD ADVANCEMENT FEE WITH THE REGIONAL TOURNAMENT DIRECTOR. THE ADVANCEMENT FEE IS EXPECTED TO BE PAID BEFORE LEAVING THE REGIONAL TOURNAMENT. NO REFUNDS



2025

EASTERN NATIONAL

FLOWRESTLING
OFFICIAL LIVE STREAM PARTNER

WRESTLING CHAMPIONSHIPS

CONGRATULATIONS!

You have just qualified to enter the 2025 Eastern National Middle Atlantic Wrestling Association Championship. You are a member of a select group of athletes who remain eligible for this competition. I hope that you will find this experience of positive value. I wish to extend my best to you for successful competition in the spirit of good sportsmanship. If I can be of service to you, feel free to contact me.

Sincerely,

Wade Winemiller, Tournament Director (717) 779-4303 mawawade@yahoo.com

HOTEL QUESTIONS:

EventConnect Support 1-888-723-2064 x823 events@eventconnect.io

Robely Rivera (410) 548-4914 or (443) 614-0948 rrivera@wicomicocounty.org

DATE: May 2, 2025 – May 4, 2025

LOCATION: Wicomico Civic Center, 500 Glen Avenue, Salisbury, MD 21804

ELIGIBILITY: Must have placed 1st, 2nd, 3rd or 4th in the Regional Tournaments. 5th & 6th placement winners are alternates. Everyone must have proof of age if challenged including the person issuing the challenge. Girls Only Divisions qualify the top 4 place winners for advancement in 2025. 5th & 6th placement winners are alternates.

ENTRY FEE: **\$30.00 CASH or \$32.00 CARD** to be collected at the Regional Tournament. **THE ADVANCEMENT FEE IS EXPECTED TO BE PAID BEFORE LEAVING THE REGIONAL TOURNAMENT. NO REFUNDS**

AWARDS: Middle Atlantic Wrestling Association plaques will be awarded to the first eight place winners. Contestants must be in proper uniform to receive awards. No caps, hats, T-shirts nor street clothes will be permitted on the awards stand. A professional photographer will be available. No awards will be given out in advance of the awards ceremony.

UNIFORMS: Singlets or two-piece uniforms are required. HEADGEAR IS MANDATORY, except Open Division.

LENGTH OF BOUTS: Open, Elite, Advanced, Intermediate, Junior Girls and Elite Girls: Three 1½ minute periods. All others: Three one-minute periods. Overtime sudden death: One 1-minute period followed by a 30 second period if necessary.

2025 EASTERN NATIONAL CHAMPIONSHIPS TIME SCHEDULE

FRIDAY, MAY 2

1:00 PM – 2:30 PM

Mandatory weigh-ins for **ELITE GIRLS** division **ONLY** in the **Flanders Room** at the Wicomico Civic Center.

4:00 PM – Wrestling begins for the **ELITE GIRLS** division ONLY!

5:00 PM – 9:00 PM

Mandatory weigh-ins for **ALL** other divisions except Open in the **Flanders Room** at the Wicomico Civic Center. Open Division may weigh-in at this time. Two pound weight allowance for all Divisions. Open Division weigh-ins will also be held in the Flanders Room on Saturday from 4:30 to 5:00 PM and Sunday from 7:00 to 7:30 AM.

SATURDAY, MAY 3

7:00 AM – Doors open for spectators.

8:00 AM – Opening Ceremony.

8:45 AM Wrestling begins for Bantam, Midget, Junior and Intermediate divisions. Preliminary bouts, first round consolation (preliminary losers), quarter finals, second round consolations (1st round consolation winner vs quarter final loser)

11:00 AM – Wrestling begins for Bantam Girls, Midget Girls, Junior Girls and Elite Girls divisions.

1:00 PM – Wrestling begins for Advanced and Elite divisions.

*****ALL GIRLS ONLY DIVISIONS BRACKETS WILL WRESTLE TO COMPLETION ON SATURDAY*****

ALL AWARDS WILL BE PRESENTED AT THE CONCLUSION OF EACH DIVISION. NO AWARDS WILL BE GIVEN IN ADVANCE OF THE PRESENTATIONS AND NO AWARDS WILL BE PRESENTED TO THOSE WHO FORFEIT THEIR CONSOLATION BOUT EXCEPT IN CASE OF INJURY. THOSE WISHING TO HAVE THEIR AWARD SENT MUST LEAVE **\$20.00 (CASH ONLY) FOR SHIPPING.**

SUNDAY, MAY 4

7:00 AM – Doors open for spectators.

8:00 AM – Wrestling begins. Semi-Finals & 3rd round consolations, fourth round consolations, and 1st, 3rd, 5th, and 7th place bouts. Open Division will begin as soon as possible after weigh-ins and continue until completion.

ALL AWARDS WILL BE PRESENTED AT THE CONCLUSION OF EACH DIVISION. NO AWARDS WILL BE GIVEN IN ADVANCE OF THE PRESENTATIONS AND NO AWARDS WILL BE PRESENTED TO THOSE WHO FORFEIT THEIR CONSOLATION BOUT EXCEPT IN CASE OF INJURY. THOSE WISHING TO HAVE THEIR AWARD SENT MUST LEAVE **\$20.00 (CASH ONLY) FOR SHIPPING.**

NO OVERNIGHT PARKING IS PERMITTED AT THE WICOMICO CIVIC CENTER

Per Wicomico Youth & Civic Center policy: Athletes may bring in one energy/protein bar, one plastic (sealed) water bottle , and a empty water container(non-metal). *This is not a MAWA policy.*

SPECTATOR ADMISSION:

Free Spectator Admission Friday for Elite Girls division

\$10 Floor Pass Friday Elite Girls division

\$20 Adults each day

\$5 Students each day

\$30 Floor Pass each day (includes admission)

\$50 Combo Sat/Sun Floor Pass (includes admission)

NO REFUNDS FOR ANY REASON | ALL credit card transactions are subject to a \$2.00 service fee!

Coaches must have a Floor Pass to gain admission to the floor. Once the match is complete the wrestler and his coach must exit from the floor. You cannot return until your next bout.

Hotel Information / Questions

EventConnect Support 1-888-723-2064 x823
events@eventconnect.io

Robely Rivera, (410) 548-4914 or (443) 614-0948

rrivera@wicomicoounty.org

MAWA EASTERN NATIONAL HOTEL INFORMATION

Click [HERE](https://app.eventconnect.io/events/36940/hotels?nav=hidden)

<https://app.eventconnect.io/events/36940/hotels?nav=hidden>



NO OVERNIGHT PARKING IS PERMITTED AT THE WICOMICO CIVIC CENTER

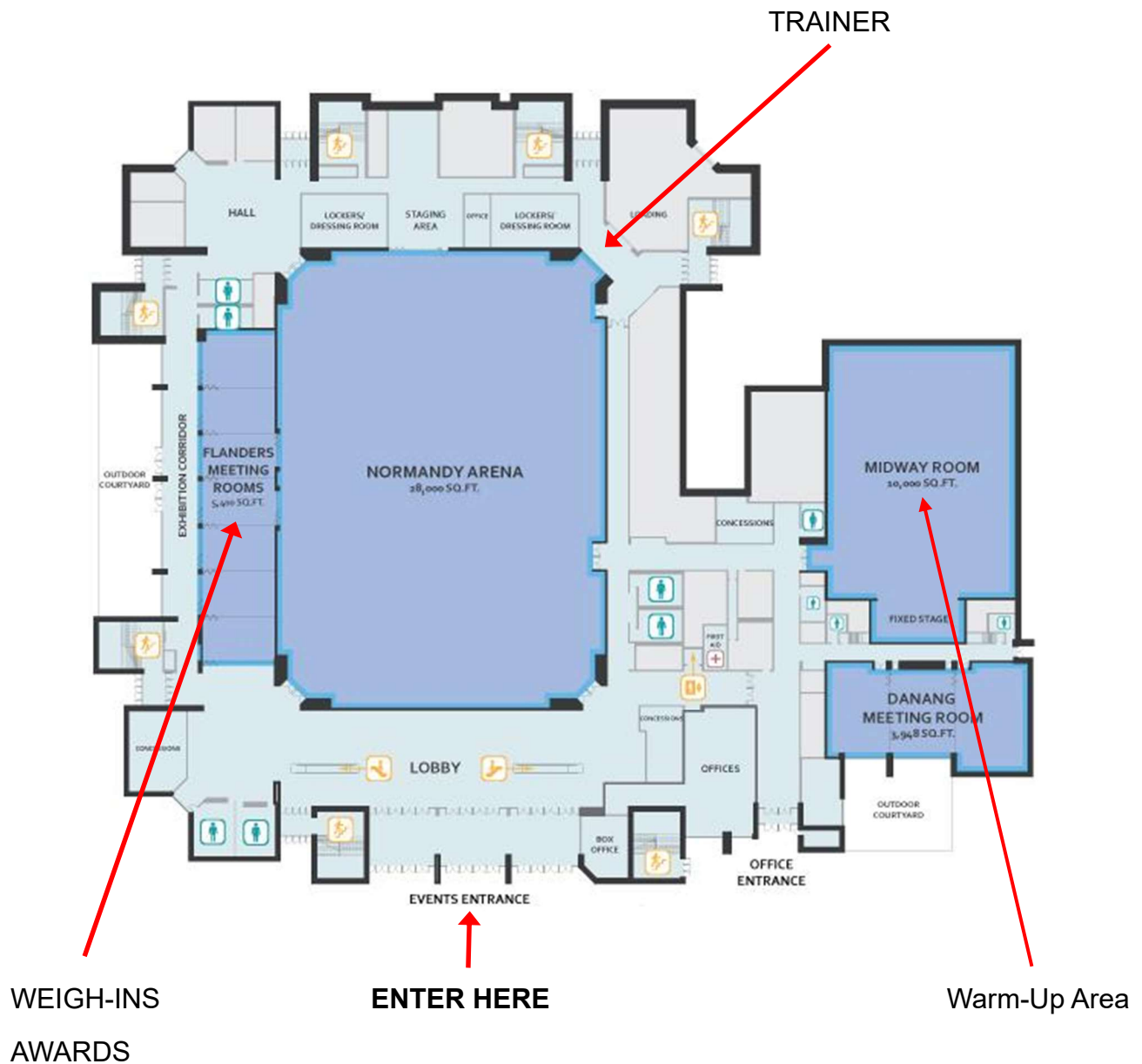

All persons **MUST** use the Events Entrance on Friday, Saturday, and Sunday. Please do not attempt to use any other entrances to the facility. Weigh-ins will be held in the Flanders Rooms on Friday from 5:00 PM – 9:00 PM. All awards will be presented in the Flanders Room on Saturday and Sunday.

Per Wicomico Youth & Civic Center policy: Athletes may bring in one energy/protein bar, one plastic (sealed) water bottle , and a empty water container(non-metal). This is not a MAWA policy.

FLOWRESTLING OFFICIAL LIVE STREAM PARTNER

Click [HERE](#) to watch ALL 2025 Regional Tournaments and the Eastern National Championships

